

# PEN16-0048 General Plan Amendment

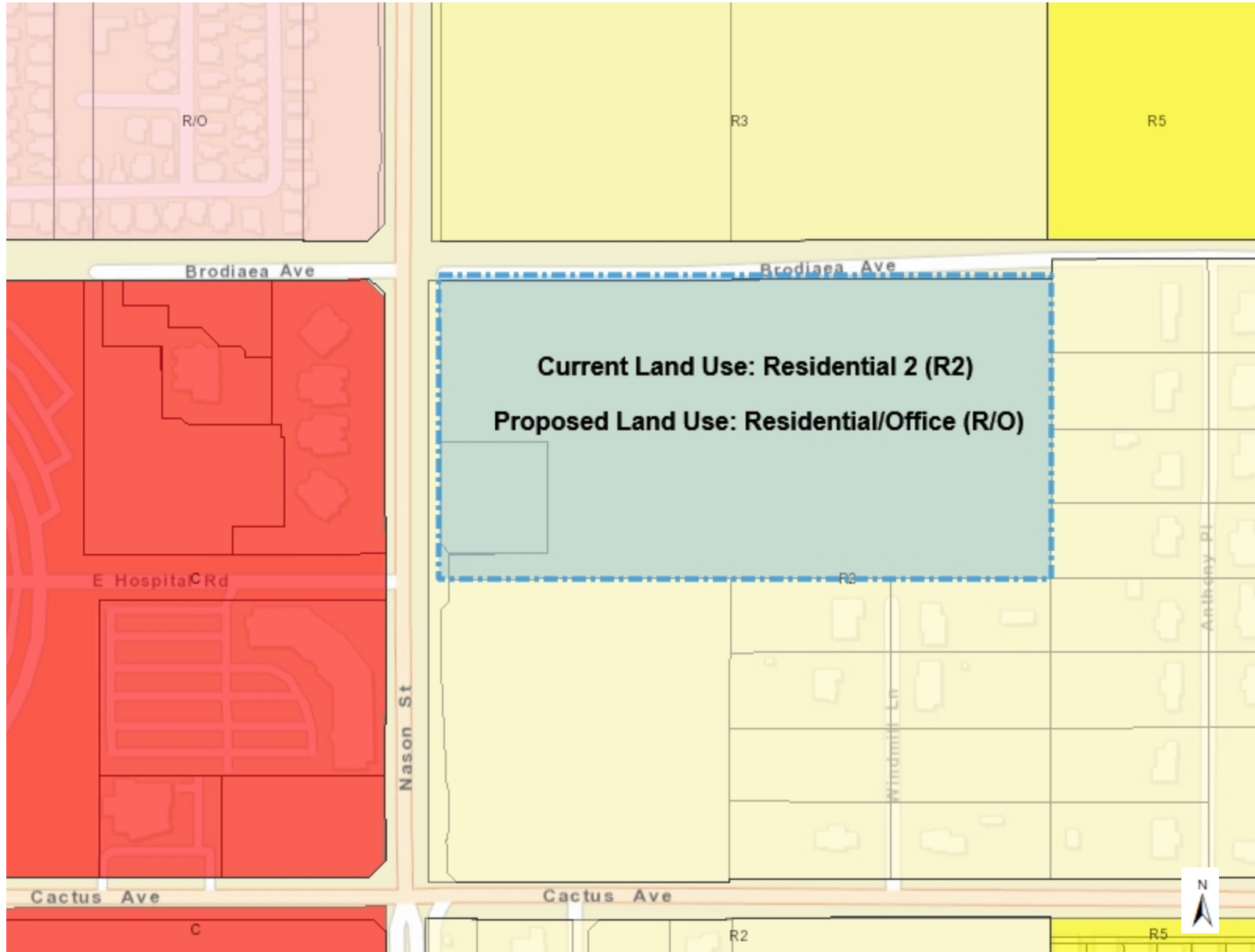

## Legend

### Land Use

- Residential: Max. 1 du/ac
- Mixed Use
- Residential: Max. 2 du/ac
- Rural Residential: Max 2.5 du/ac
- Residential: Max. 3 du/ac
- Residential: Max. 5 du/ac
- Residential: Max. 5 or 15 du/ac
- Residential: Max. 10 du/ac
- Residential: Max. 15 du/ac
- Residential: Max. 20 du/ac
- Residential: Max. 30 du/ac
- Hillside Residential
- Planned Residential
- Residential/Office
- Office
- Commercial
- Business Park/Light Industrial
- Open Space
- Public Facilities
- Floodplain
- Parcels
- City Boundary

## Notes

APNs: 486-290-036 & 037  
Proposed General Plan Amendment  
from Residential 2 (R2) to  
Residential/Office (R/O).

631.0      0      315.48      631.0 Feet