

LAND USE

EXISTING

PROPOSED

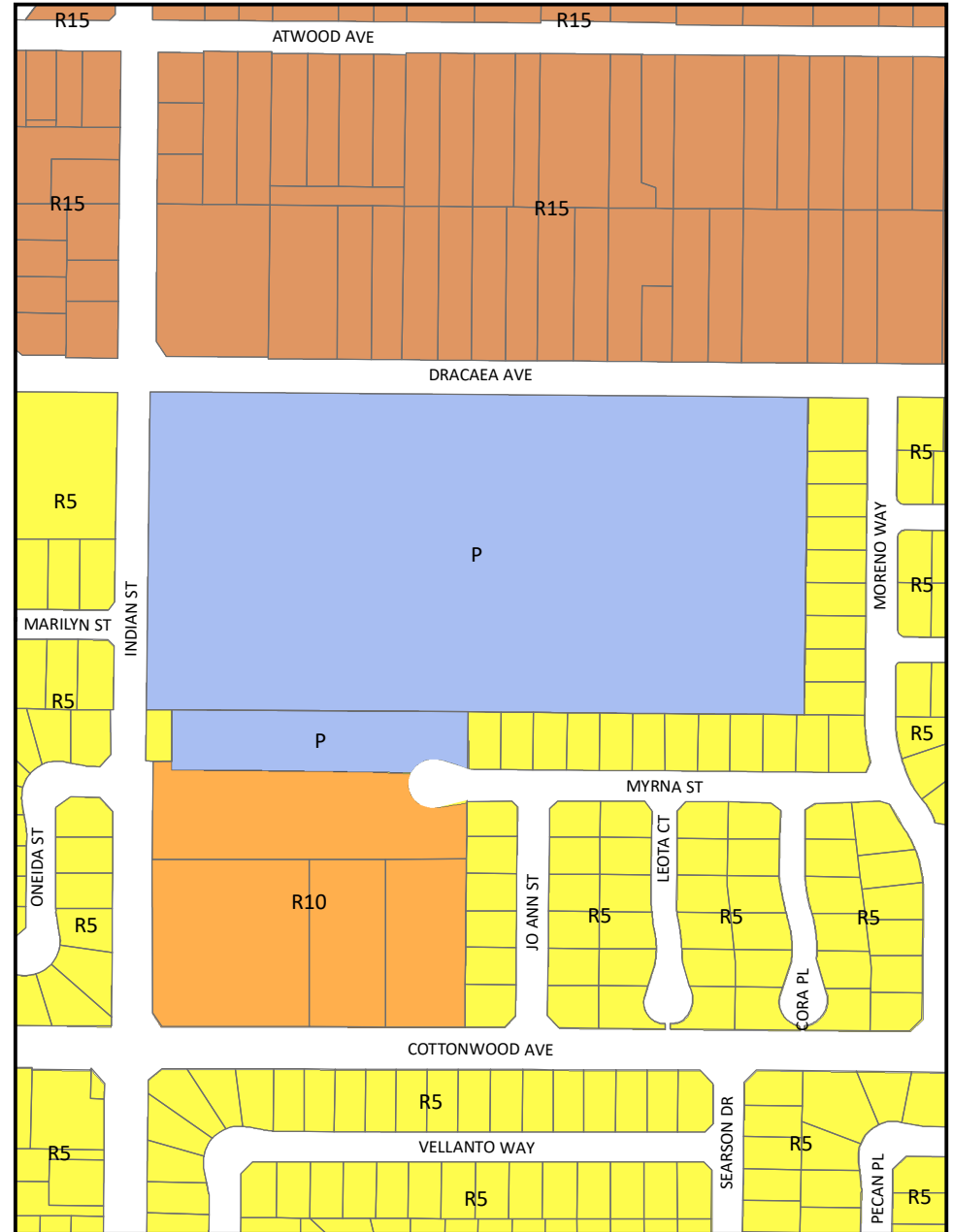
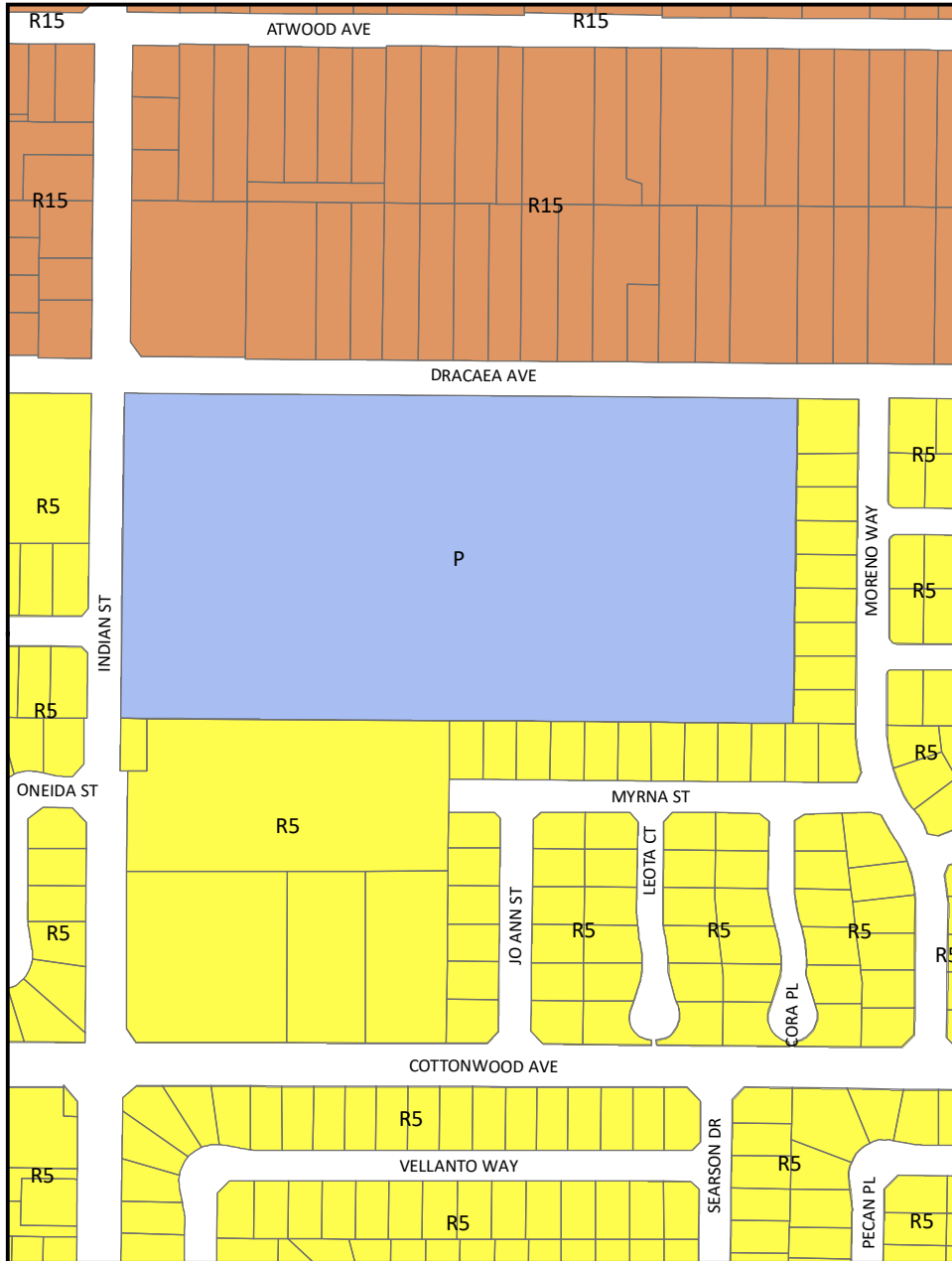

The information shown on this map was compiled from the Riverside County GIS and the City of Moreno Valley GIS. The land base and facility information on this map is for display purposes only and should not be relied upon without independent verification as to its accuracy. Riverside County and City of Moreno Valley will not be held responsible for any claims, losses or damages resulting from the use of this map.

Parcels	Residential: Max. 3 du/ac	Residential: Max. 20 du/ac	Office
Residential: Max. 1 du/ac	Residential: Max. 5 du/ac	Residential: Max. 30 du/ac	Commercial
Mixed Use	Residential: Max. 5 or 15 du/ac	Hillside Residential	Business Park/Light Industrial
Residential: Max. 2 du/ac	Residential: Max. 10 du/ac	Planned Residential	Open Space
Rural Residential: Max 2.5 du/ac	Residential: Max. 15 du/ac	Residential/Office	Public Facilities
			Floodplain

